

# CONQUEROR HEAVY DUTY STAINLESS STEEL HINGED CABLE CLEAT

## CONQUEROR (RTSS) THE FULLY VERSATILE CABLE CLEAT

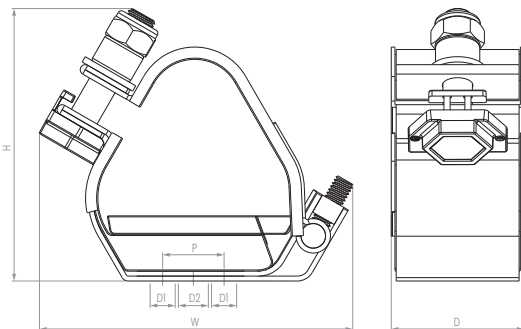

### TECHNICAL DATA & CLASSIFICATION

TYPE	6.1.3 Composite RTSS - Range Taking Stainless Steel
DESIGN SPECIFICATION	IEC 61914
TEMPERATURE FOR PERMANENT APPLICATION	-60°C to +60°C IEC 61914 clause 6.2
NEEDLE FLAME TEST	Pass - 120 second flame application time IEC 61914 clause 10.0, 10.1, IEC 60695-11-5
LATERAL LOAD TEST	IEC 61914 clause 9.3
AXIAL LOAD TEST	0.9kN - 1.1kN, IEC 61914 clause 9.4
IMPACT RESISTANCE	Pass - Very heavy IEC 61914 clause 6.3, 6.3.5, 9.2
MATERIAL	316L Stainless Steel with Standard Polymer Liner Standard Polymer Liners are classified as Low Smoke & Fume (LSF), Zero Halogen (LS0H) and Phosphorus Free

### SHORT CIRCUIT TESTING TO IEC 61914 - CLAUSE 9.5

TREFOIL FORMATION				
One short circuit 300mm fixed cleat centres	One short circuit 300mm fixed cleat centres	Two short circuits 600mm fixed cleat centres	One short circuit 600mm fixed cleat centres	Two short circuits 600mm fixed cleat centres
0.1 sec	1 sec	0.1 sec	3 sec	1 sec
170kA Peak	90kA Peak	131kA Peak	61kA Peak	80kA Peak
77.3kA r.m.s	43.2kA r.m.s	59.6kA r.m.s	29.1kA r.m.s	38.1kA r.m.s

### 300MM CONQUEROR RTSS (0.1 SEC)

CABLE OD (MM)	PEAKKA
36	170.0
38	174.6
43	185.7
59	217.6
65	228.4

### CABLE CLEAT SELECTION TABLE

CONQUEROR PART NO.	CABLE Ø RANGE TAKE (MM)	DIMENSIONS (MM)						WEIGHT (g)
		W	H	D	P	FIXING HOLE Ø		
						D1	D2	
RTSS023032	23-32	122	99	54	25	2 x M10	1 x M12	509
RTSS030039	30-39	126	111	54	25	2 x M10	1 x M12	534
RTSS037046	37-46	132	117	54	25	2 x M10	1 x M12	557
RTSS044053	44-53	151	128	54	50	2 x M10	1 x M12	676
RTSS051060	51-60	154	139	54	50	2 x M10	1 x M12	694
RTSS058067	58-67	157	151	54	50	2 x M10	1 x M12	727
RTSS065074	65-74	176	163	54	75	2 x M10	1 x M12	839
RTSS072081	72-81	182	175	54	75	2 x M10	1 x M12	866
RTSS079088	79-88	191	190	54	75	2 x M10	1 x M12	900
RTSS086095	86-95	216	202	54	75	2 x M10	1 x M12	1023
RTSS093102	93-102	222	215	54	75	2 x M10	1 x M12	1050
RTSS100109	100-109	228	228	54	75	2 x M10	1 x M12	1079
RTSS107116	107-116	254	241	54	75	2 x M10	1 x M12	1199
RTSS114123	114-123	257	254	54	75	2 x M10	1 x M12	1228
RTSS121130	121-130	268	267	54	75	2 x M10	1 x M12	1255

Coatings are available upon request by adding the following suffixes to the ordering reference - EC for epoxy coating, PC for polyester coating and TC for thermoplastic coating. Example order reference for epoxy coating suffix EC (RTSS065074EC). Fasteners required to secure the cable cleat to the support structure are not included but can be supplied upon request - see cleat fixing pack TDS752. Isolation/separation pads (to prevent corrosion between two dissimilar metals) are not included but can be supplied on request - see isolation/separation pad TDS736.

## CONQUEROR HEAVY DUTY STAINLESS STEEL HINGED CABLE CLEAT

### CONQUEROR (RTSS) THE FULLY VERSATILE CABLE CLEAT

Conqueror has been designed to suit a wide cable range take, allowing one cleat to fit a much broader range of cable sizes than a conventional fixed hinge cable cleat.

A common problem when ordering cable is that the actual outer cable diameter may vary from the nominal size by as much as 5%. If the cable diameter is at the upper or lower limit of a fixed hinge cable cleats range, this could result in the cleat being either too small or too large to properly restrain the cables. When this happens during a project,

especially one situated in a remote location, there will be delays and additional costs to re-order cleats of the correct size.

The Conqueror can easily cope with these size fluctuations, reducing the need for multiple cleat sizes to safely clamp the cables. The simple and easy-to-use adjustable hinge of the conqueror cable cleat allows each of the 16 sizes to provide a cable range take of 9mm, almost twice that of other fixed hinge cable cleats.

#### CABLE RANGE CAPABILITIES

Each of the 15 sizes has 9mm range take. Range-taking bolt allows the Conqueror to safely clamp cables within its 9mm range.

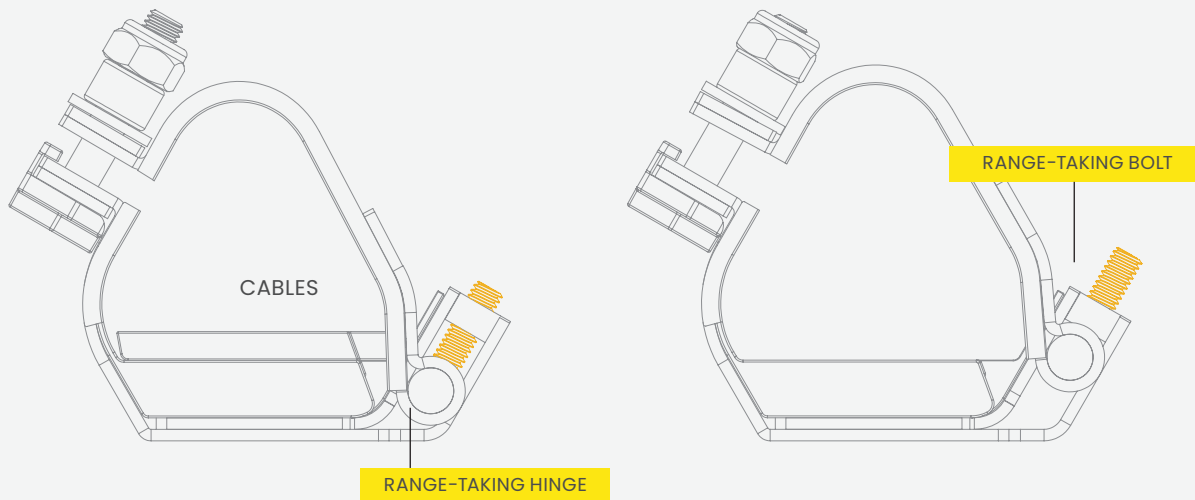

The Conqueror cable cleats are metallic cable cleats designed, constructed, and tested in accordance with the International Standard 'cable cleats for Electrical Installations' IEC 61914. The Conqueror cable cleat has been designed to restrain a large cable range take, and tested for exceptionally high short circuit conditions on cables held in trefoil application / formation, to ensure the securing and retention of cables without damage.

Conqueror is unique with its patent pending adjustable hinge. The movement of this hinge virtually doubles the range take adjustment when compared to other fixed hinged products on the market. Conqueror covers a range of cable diameters from 19mm up to 130mm in only 15 sizes. The cable cleat is fabricated from 316L stainless steel, giving it high creep strength whilst providing excellent corrosion resistance in the harshest of environments.

The Conqueror cable cleat has one M12 and two M10 fixing clearance holes within its base, allowing versatility to the installer during installation, and is designed to enable the product to be secured to a variety of mounting surfaces. The cable cleat hinge opens fully, allowing the cables to be easily placed within the cable cleat, to aid the installer before closing and securing via the mouth piece bolt.

The Conqueror cable cleats come with a liner as standard which help to restrain the cable(s) within vertical applications. The liner also provides a layer of protection between the cable sheath and the cable cleat during normal operation, where thermal elongation of cables occurs. This additional layer protects the cable from chafing on any mounting surface due to differential movements such as those found in marine and offshore applications. The liners also assist in the extra protection of cable(s) in the event of short circuit fault conditions. The standard liners supplied are classified as Low Smoke & Fume (LSF), Zero Halogen (LS0H) and Phosphorus Free.

#### FEATURES

- Third party certification to IEC 61914
- 316L stainless steel
- 23-130mm in 15 sizes for trefoil formation / application
- Short circuit rating of 170kA peak fault
- Operating temperature -60°C to +60°C
- Standard Polymer Liners are classified as Low Smoke and Fume Zero Halogen (LSF0H), Phosphorus-free
- Combined single (M12) and two bolt (M10) fixing design